



DSF-42B8W00

INSTALLATION INSTRUCTIONS



Notes before installation:

1. Please check that all components are present.
2. Before installation ensure that all feed lines are clear of debris and on/off valve is present.
3. Ensure water pressure is between 20-125 PSI (Includes combination of hot and cold feed lines).
4. Pictures in the manual are general in content and may not represent exactly your purchased faucet. If you are having difficulties please contact a professional plumber.
5. If you will be away from home for an extended period you should shut off the main water supply.

Daily maintenance

1. Use a soft cloth and vinegar to remove hard-water spots.
2. Check aerator (if present) regularly for calcium build up or when water stream is not optimum.
3. DO NOT use caustic cleaning products as the use will break down finish and will void the product warranty.
4. Acceptable cleaners include vinegar or mild non-abrasive liquid detergents.
5. If the water pressure appears to be less than optimum remove, inspect, clean or replace aerator.

Tools you will need:

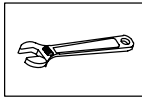

Adjustable Wrench

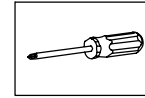

Philips Screwdriver

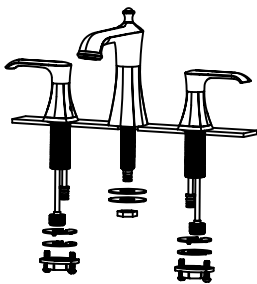

1. Remove three way connector. Remove mounting hardware assembly.

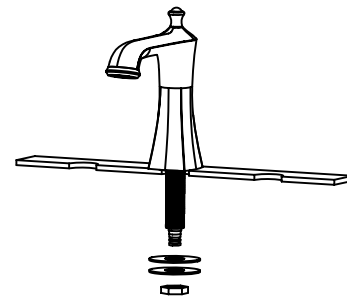

2. place faucet body through 1-1/4" hole in countertop or sink with base o-ring attached

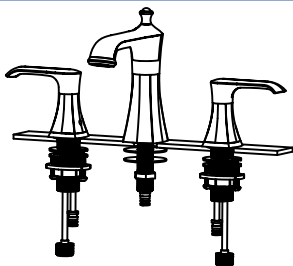

3. Put the handle through the hole, reinstall the rubber washer, followed by the metal washer and lock nut.

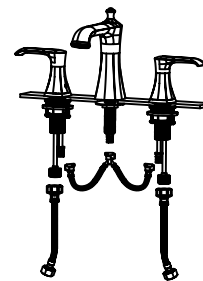

4. Connect the flexible hoses to the valve bodies. Left hose is for hot water, right is for cold. Connect valve bodies with valve outlets with flexible hoses.

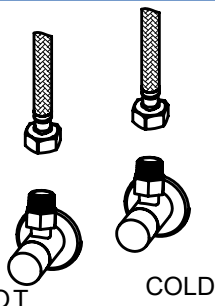

5. Attach flexible hoses to water supply.

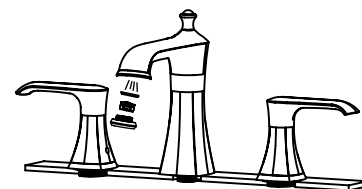

6. Remove the aerator and turn on the faucet for 1 minute to flush debris from faucet and feed lines. Turn faucet off and reassemble aerator.